

PLUS SERIES

Improving the thermal performance of the building envelope is a key aspect when looking for energy efficient building materials.

Product Overview

The Nudura Plus+ Forms are engineered to address the growing industry demand for increased exterior insulation. The Nudura Plus+ Forms come factory ready for installation. With this innovative design all of the key benefits of Nudura can be used. DURALOK Technology® allows installers the ability to install faster and more efficiently. DURAMAX Technology® allows builders the advantage of placing the largest standard form in the ICF Industry. DURAFOLD Technology® ships flat, reducing overall shipping costs, maximizing storage space on site, simply unfold and stack. The innovative reversible design, reduces waste on-site.

The Nudura Plus+ Forms are available in four sizes: 1in (25mm), 2in (51mm), 4in (102mm) and 6in (152mm) offering R-values as high as R-48 (RSI 8.45, U-Value 0.12). The focus of today's property owners, designers, building developers and contractors is to build environmentally sustainable buildings, that meet their personal needs, code standards, and the needs of their clients.

Features & Benefits

- 1" (25mm) R-value 28 & U-value 0.21, 2" (51mm) R-value 32 & U-value 0.18, 4" (102mm) R-value 40 & U-value 0.15, and 6" (152mm) R-value 48 & U-value 0.12
- Features Nudura's innovative patented technology
- Industry's largest standard form on the market (8ft [2438mm])
- Ready for installation

Improving the thermal performance of the building envelope is a key aspect when looking for energy efficient building materials. Optimizing R-Value with thermal mass has shown to be the best method of providing significant energy savings to building owners.

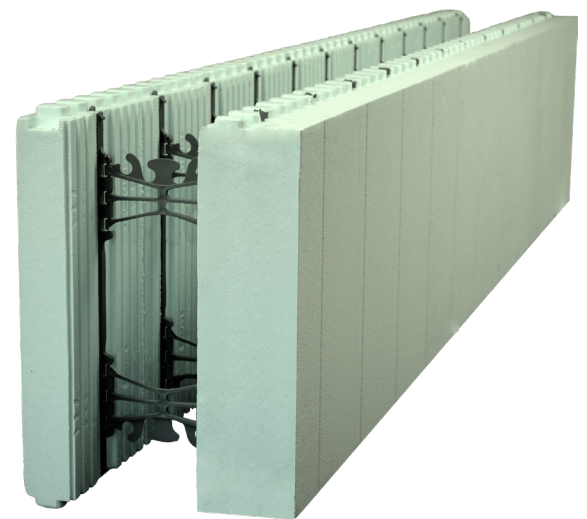
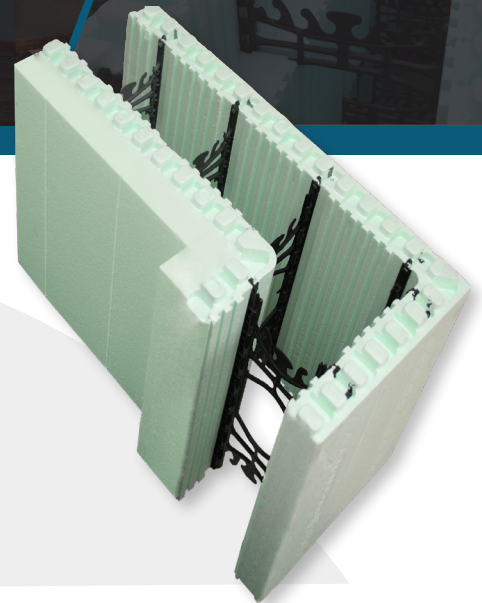

R-Value Inserts

The Nudura R-Value Plus+ inserts allow the ability to customize the desired amount of insulation needed to meet the specific requirements of any project. The inserts are available in 4 standard sizes: 1in (25mm), 2in (51mm), 4in (102mm) and 6in (152mm) and all 32in (812mm) long. Custom combinations can be created to provide further insulation value if desired and are compatible with core sizes ranging from 6" (150mm) to 12" (300mm).

The R-Value Inserts were engineered to integrate into any Nudura form unit, allowing for increased R-Values, while at the same time not interfering with the unique technological characteristics of Nudura Forms. The Nudura line of forms offer innovation that is exclusive to Nudura, which allow builders, architects and engineers the ability to build and design commercial and residential structures with greater efficiency. The DURAFOLD®, DURAMAX® and DURALOK® Technologies along with our 4-Way Reversible System, offer patented technology that is only available from Nudura, in all form sizes.

Using the R-Value Plus+ insert is easy. Once the desired size is chosen, the R-Value Insert is simply slid into one side of a Nudura form unit. With the unique dovetail system, the inserts are securely placed during the construction process. Because of the unique form attributes that Nudura offers, the speed of construction is increased over conventional building methods and other insulated concrete form products on the market. With the R-Value Inserts Nudura provides R-Values that meet and exceed code for sustainable homes and offer R-Values from R-31 (RSI 5.46 and U-Value 0.18) to as high as R-47 (RSI 8.28 and U-value 0.12).

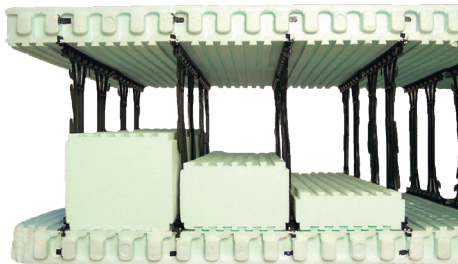

Available thicknesses

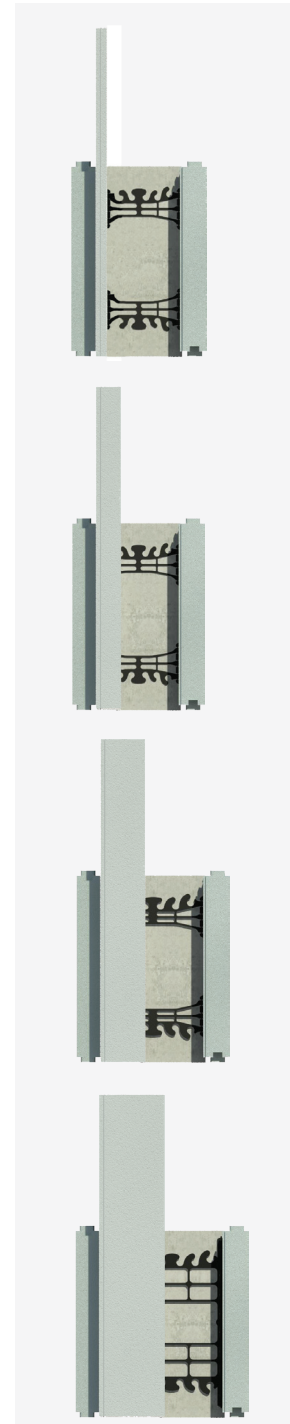

1" (25mm)
R-value 31
RSI- 5.46
U-Value- 0.18

2" (50mm)
R-value - 33
RSI 5.81
U-Value 0.17

4" (100mm)
R-value - 40
RSI 7.05
U-Value 0.17

6" (150mm)
R-value - 47
RSI 8.28
U-Value 0.12

Nudura Inc. | 27 Hooper Road, Unit 10 | Barrie, ON L4N 9S3 | 866.468.6299 | nudura.com

Tremco CPG brings together Tremco Incorporated's Commercial Sealants & Waterproofing and Roofing & Building Maintenance operating divisions; Dryvit Systems, Inc.; Nudura Inc.; Willseal; Weatherproofing Technologies, Inc. and Weatherproofing Technologies Canada, Inc.



Construction Products Group

Nudura® is a registered trademark of Nudura Inc.
Use of the ® symbol indicates registration with the US Patent & Trademark Office and the Canadian Intellectual Property Office.

07/2020

tremcocpg.com