

DISCLAIMER NOTICE:
 SPECIFIC INFORMATION
 REQUIRED FOR COMPLIANCE
 WITH LOCAL CODES IS THE
 RESPONSIBILITY OF THE
 DESIGNER

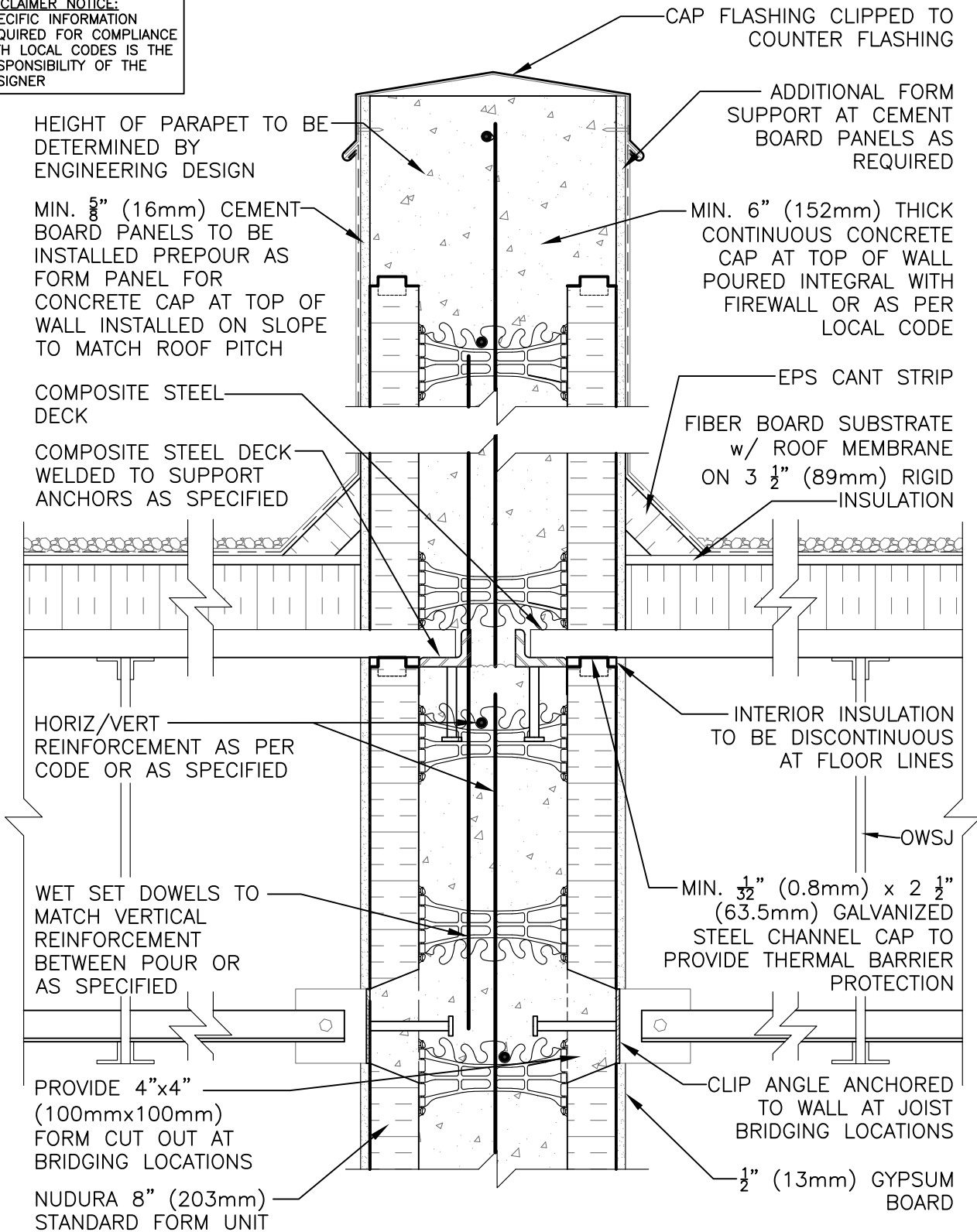

HEIGHT OF PARAPET TO BE DETERMINED BY ENGINEERING DESIGN

MIN. 5" (16mm) CEMENT BOARD PANELS TO BE INSTALLED PREPOUR AS FORM PANEL FOR CONCRETE CAP AT TOP OF WALL INSTALLED ON SLOPE TO MATCH ROOF PITCH

COMPOSITE STEEL DECK

COMPOSITE STEEL DECK WELDED TO SUPPORT ANCHORS AS SPECIFIED

HORIZ/VERT REINFORCEMENT AS PER CODE OR AS SPECIFIED

WET SET DOWELS TO MATCH VERTICAL REINFORCEMENT BETWEEN POUR OR AS SPECIFIED

PROVIDE 4"x4" (100mmx100mm) FORM CUT OUT AT BRIDGING LOCATIONS

NUDURA 8" (203mm) STANDARD FORM UNIT

CAP FLASHING CLIPPED TO COUNTER FLASHING

ADDITIONAL FORM SUPPORT AT CEMENT BOARD PANELS AS REQUIRED

MIN. 6" (152mm) THICK CONTINUOUS CONCRETE CAP AT TOP OF WALL POURED INTEGRAL WITH FIREWALL OR AS PER LOCAL CODE

EPS CANT STRIP

FIBER BOARD SUBSTRATE w/ ROOF MEMBRANE ON 3 1/2" (89mm) RIGID INSULATION

INTERIOR INSULATION TO BE DISCONTINUOUS AT FLOOR LINES

OWSJ

MIN. 1/32" (0.8mm) x 2 1/2" (63.5mm) GALVANIZED STEEL CHANNEL CAP TO PROVIDE THERMAL BARRIER PROTECTION

CLIP ANGLE ANCHORED TO WALL AT JOIST BRIDGING LOCATIONS

1/2" (13mm) GYPSUM BOARD



NUDURA

INTEGRATED BUILDING TECHNOLOGY

Building Value.

NUDURA 8" (203mm) FORM UNIT
 STEEL JOIST ROOF DETAIL
 NON-BEARING DEMISING WALL

REV. NO. 000	DWG NO. G8C04
DATE: APRIL 2010	
DRAWN BY: K. STILL	SCALE: 1 : 8