

ALLOW ROOF SLAB  
TO REST ON TO  
BEARING WALL  
CONCRETE

FORM PANELS c/w  
INSERT WEBS- CUT TO  
SUIT ROOF  
CONNECTION-  
ADDITIONAL FORM  
SUPPORT AS REQUIRED

FIBER BOARD SUBSTRATE  
w/ ROOF MEMBRANE  
ON 3 1/2" (89mm) RIGID  
INSULATION

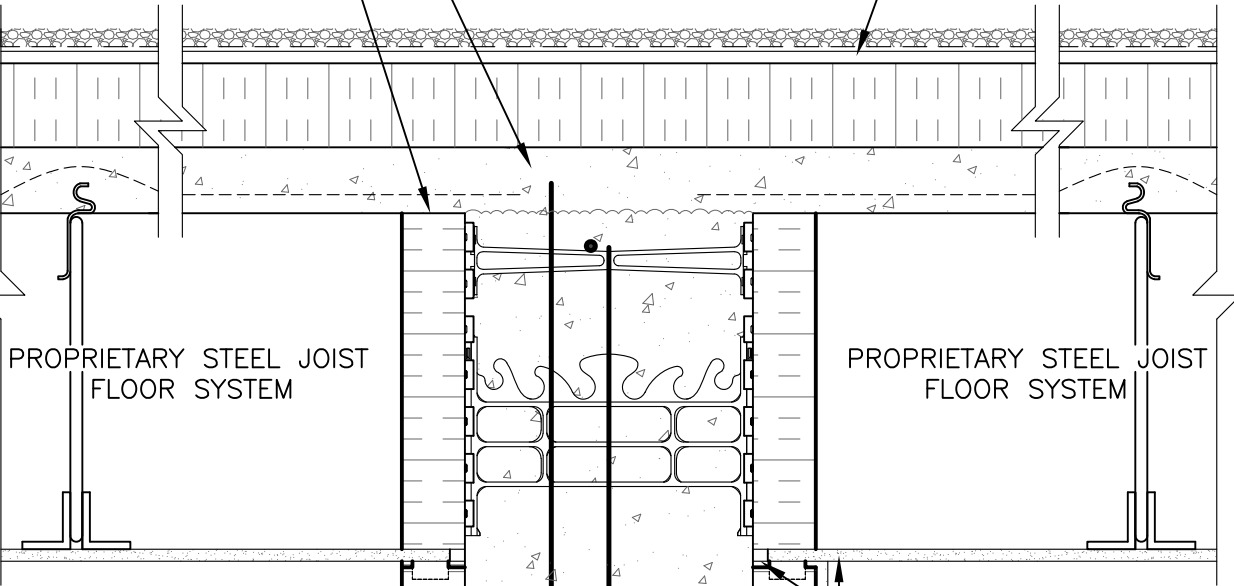

PROPRIETARY STEEL JOIST  
FLOOR SYSTEM

PROPRIETARY STEEL JOIST  
FLOOR SYSTEM

HORIZ/VERT  
REINFORCEMENT AS  
PER CODE OR AS  
SPECIFIED

WET SET DOWELS TO  
MATCH VERTICAL  
REINFORCEMENT  
BETWEEN POUR OR  
AS SPECIFIED

NUDURA 12" (305mm)  
STANDARD FORM UNIT

CEILING FINISH AS PER STEEL  
JOIST MANUFACTURERS  
SPECIFICATION (NOTE: WHERE  
GYPSUM BOARD IS REQUIRED TO  
COMPLETE FIRE RATED ASSEMBLY,  
EPS FOAM KERF CUT TO ENABLE  
CEILING FINISH TO PROVIDE  
THERMAL BARRIER CONTACT TO  
CONCRETE)

1/2" (13mm) GYPSUM BOARD

**DISCLAIMER NOTICE:**  
SPECIFIC INFORMATION  
REQUIRED FOR COMPLIANCE  
WITH LOCAL CODES IS THE  
RESPONSIBILITY OF THE  
DESIGNER



**NUDURA**

INTEGRATED BUILDING TECHNOLOGY

*Building Value.*

NUDURA 12" (305mm) FORM UNIT  
STEEL JOIST ROOF SYSTEM  
NON-BEARING DEMISING WALL

REV. NO.  
000

DATE:  
APRIL 2010

DRAWN BY:  
K. STILL

DWG NO.

G12B04

SCALE:

1 : 8