

ALLOW FLOOR SLAB TO REST ON TO BEARING WALL CONCRETE

PROPRIETARY STEEL JOIST AND CONNECTION SHOWN BEYOND TO ALLOW FOR STAGGERING OF THE JOISTS

FIBER BOARD SUBSTRATE w/ ROOF MEMBRANE ON 3 1/2" (89mm) RIGID INSULATION

EPS FOAM REMOVED AT JOIST LOCATIONS ONLY TO ALLOW JOIST PLACEMENT

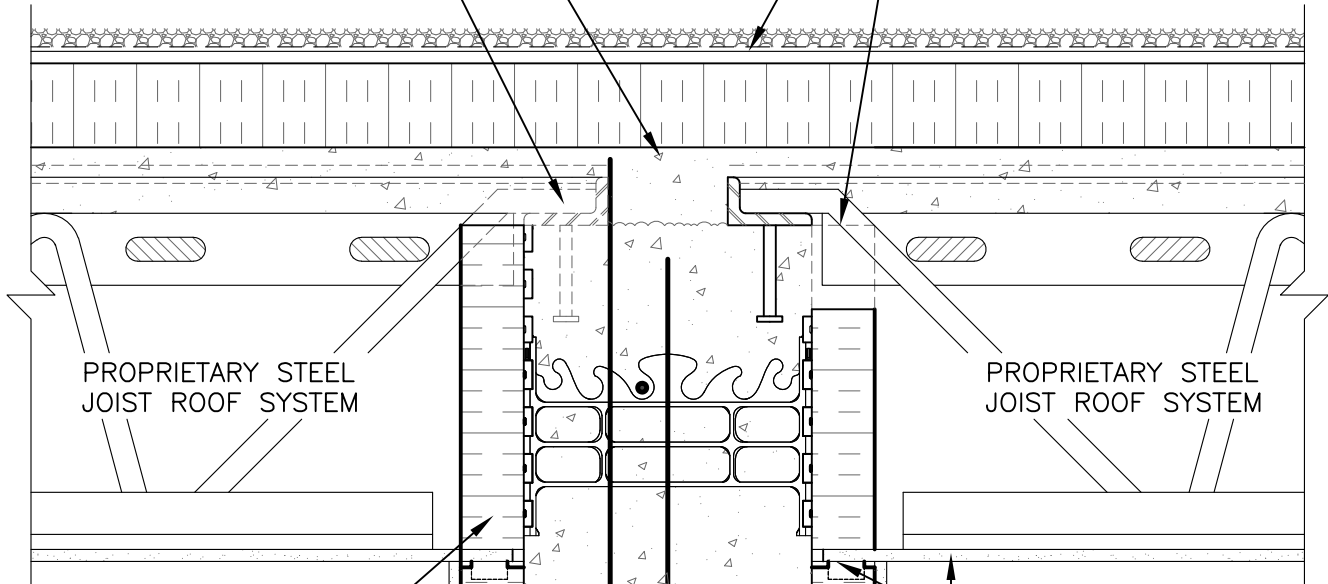

PROPRIETARY STEEL JOIST ROOF SYSTEM

PROPRIETARY STEEL JOIST ROOF SYSTEM

FORM PANELS c/w INSERT WEBS—CUT TO SUIT FLOOR CONNECTION—ADDITIONAL FORM SUPPORT AS REQUIRED

HORIZ/VERT REINFORCEMENT AS PER CODE OR AS SPECIFIED

WET SET DOWELS TO MATCH VERTICAL REINFORCEMENT BETWEEN POUR OR AS SPECIFIED

NUDURA 12" (305mm) STANDARD FORM UNIT

CEILING FINISH AS PER STEEL JOIST MANUFACTURERS SPECIFICATION (NOTE: WHERE GYPSUM BOARD IS REQUIRED TO COMPLETE FIRE RATED ASSEMBLY, EPS FOAM KERF CUT TO ENABLE CEILING FINISH TO PROVIDE THERMAL BARRIER CONTACT TO CONCRETE)

1/2" (13mm) GYPSUM BOARD

DISCLAIMER NOTICE:
SPECIFIC INFORMATION REQUIRED FOR COMPLIANCE WITH LOCAL CODES IS THE RESPONSIBILITY OF THE DESIGNER



NUDURA

INTEGRATED BUILDING TECHNOLOGY

Building Value.

NUDURA 12" (305mm) FORM UNIT
STEEL JOIST ROOF SYSTEM
BEARING DEMISING WALL

REV. NO.
000

DATE:
APRIL 2010

DRAWN BY:
K. STILL

DWG NO.

G12B03

SCALE:

1 : 8